

PROJECT LOCATION



Plot 8, Block# M, Sector# 2,
Road# 13 (50 Feet Avenue Road)
Aftabnagar, Dhaka-1219



- Soilmax Real Estate Ltd.
- Soilmax Housing Ltd.
- Soilmax Property Ltd.
- Soilmax Construction & Supplier
- Soilmax Life Foundation

HOTLINE

01745-707070

Contact Us

E-mail: soilmaxbd@gmail.com

Website: www.soilmaxrealestate.com

Office Address: House# 16, Block# G, Main Road
Banasree, Dhaka-1219

SOILMAX AL SAFA TOWER



সয়েলম্যাক্স হোক
আপনার স্বপ্ন
পূরণের সূচনা



PROJECT DETAILS



Project Name : AL SAFA TOWER
Location : Plot 8, Block# M, Sector# 2, Road# 13
 (50 Feet Avenue Road) Aftabnagar, Dhaka-1219
Land Area : 5 Katha
Building Height : G+9
Flat Size : 1450 Square Feet (+/-)
Unit : 2
Single Unit : 2900 Square Feet (+/-)

COMMON FEATURES



Our Engineer Team

Architect:
Md. Mahmudur Rahman
 B.Sc. Architect (BUET), FIAB : R-009,
 Registration Rajuk Architect
Syeda Lutfun Nassa
 Rajuk Registration No : L-008

Structural Engineer:
MD. FARIDUL ISLAM
 B. Sc. ENGG.(CIVIL) CUET
 FIEB (LIFE)
 REGISTERED ENGINEER RAJUK
GAZI SHALAUDDIN
 B. Sc. ENGG.(CIVIL) FIEB
 PRE.ENGG
 REGISTERED ENGINEER RAJUK
MD.ALOMGIR HOSSAIN
 B. Sc. ENGG.(CIVIL)

Electrical Engineer:
Md. Masud Khan
 B.Sc. Engg. (Electrical)

Plumbing Engineer:
Engr. Mazibar Rahman
 B.Sc. Engineer. (Mechanical) MIEB-35920

Auto Cad by : Tushar Imran

ADVANTAGES

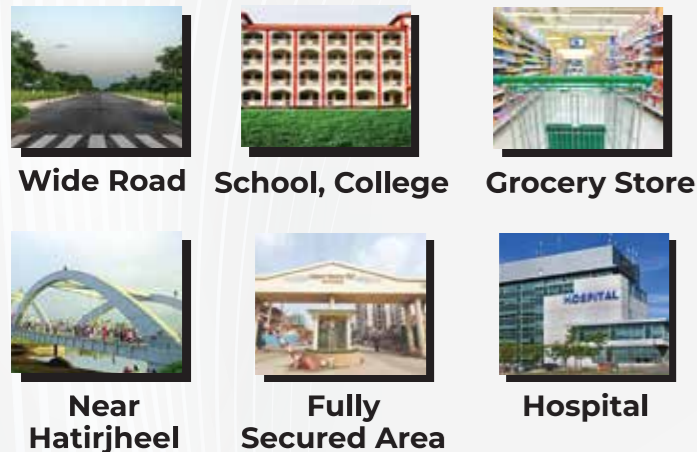

TYPICAL FLOOR



PRESENTATION PLAN (1ST TO 9TH FLOOR)

EXISTING 50'-0" WIDE ROAD

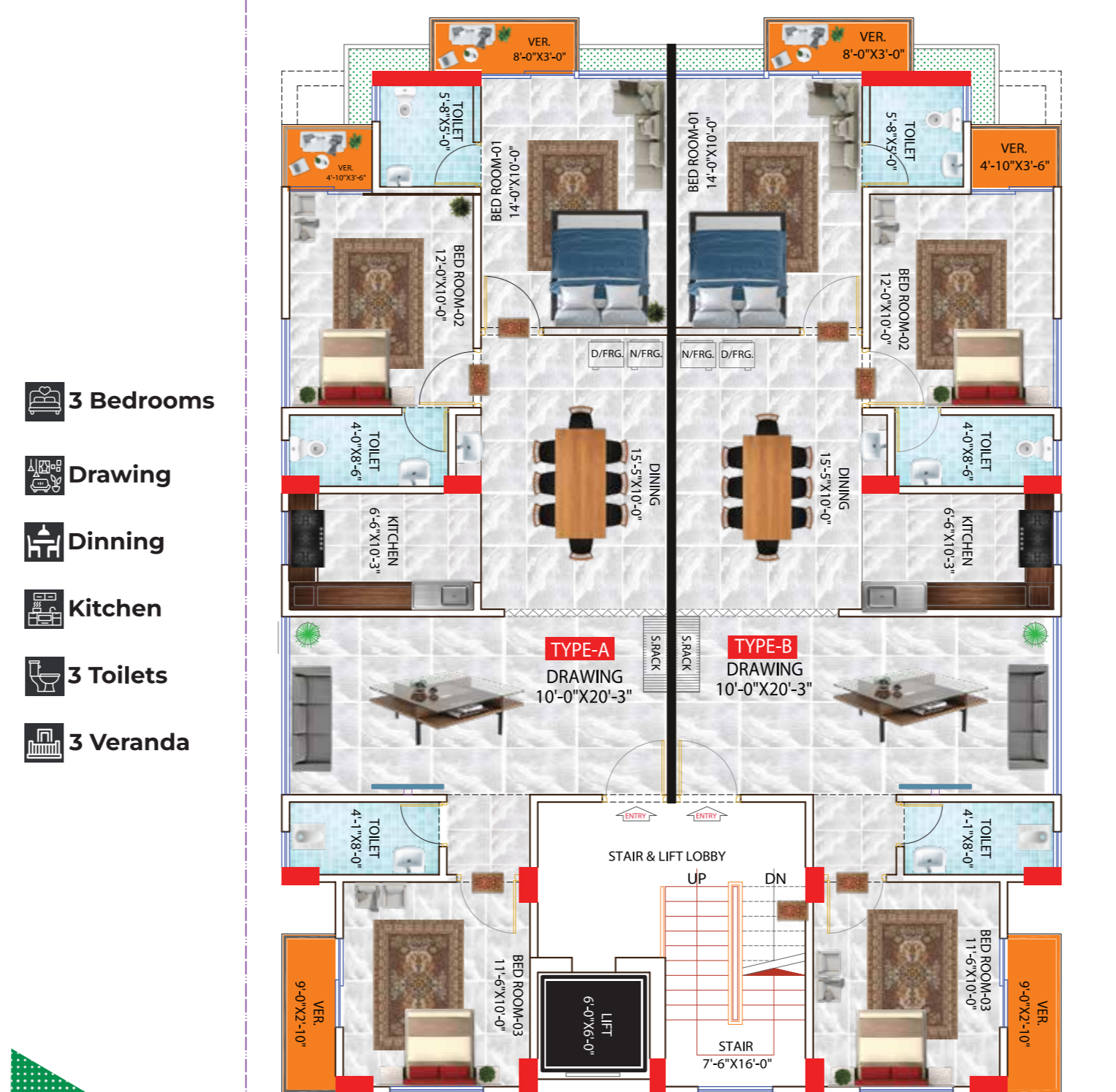

- 3 Bedrooms
- Drawing
- Dining
- Kitchen
- 3 Toilets
- 3 Veranda

PARKING



PRESENTATION PLAN (GROUND FLOOR)

EXISTING 50'-0" WIDE ROAD

